

# Leadax<sup>®</sup>

## LEADAX PROCESSING INSTRUCTIONS

- ◆ Leadax is installed and worked in a similar way to traditional lead flashing.
- ◆ Leadax can be used in any climate worldwide (-50°C/+100°C)
- ◆ Leadax can be installed from -20°C (trimming, cutting, folding and beating) At lower temperatures (< 5°C), the material is more difficult to process.
- ◆ Long lengths of Leadax can be installed without any problems. The maximum length is the length of the roll and a minimum overlap of 60 mm is sufficient.
- ◆ Overlaps can be hot air welded or sealed using Leadax sealant. The recommended welding temperature is 350-400°C. Use the (Leadax) roller to press down the welding seam.
- ◆ Use Leadax Sealant for overlaps in masonry (100 mm).
- ◆ In places and areas which are frequently exposed to wind, Leadax can be secured using Leadax Sealant. When moulded or used as facing material, we recommend securing with Leadax Sealant. Ensure that the base material is dry and clean
- ◆ Leadax can be fastened to joints using Leadax fixing clips.
- ◆ Use the Leadax roller to mould the product
- ◆ After application, remove the protective film from the face and the reverse

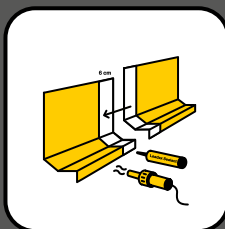

Overlap



## FREQUENTLY USED LEADAX APPLICATIONS

---

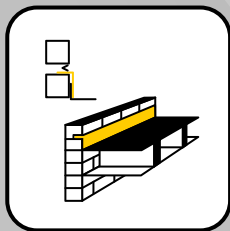

Flat roof connection

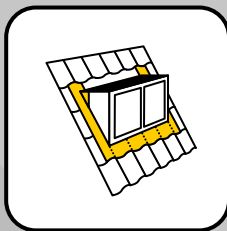

Dormer

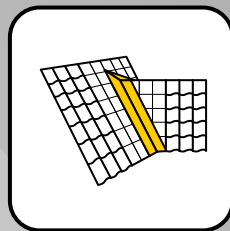

Valley gutter

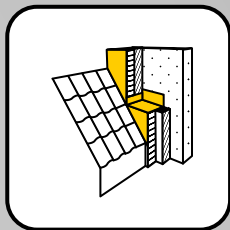

Step & cover flashing

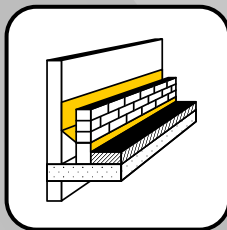

Cavity wall

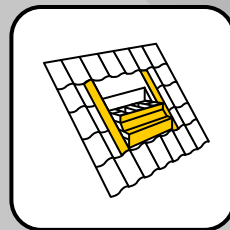

Apron flashing