

ZDC0024S Series

Overhead Door Closer

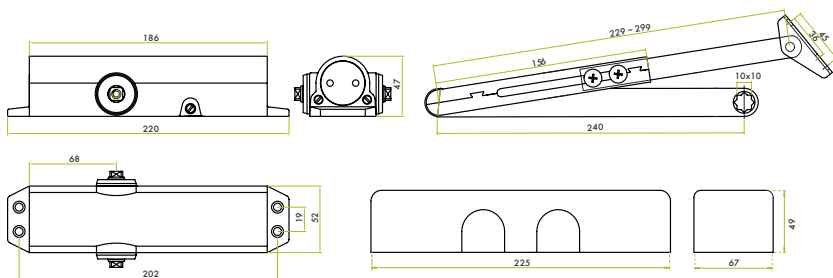
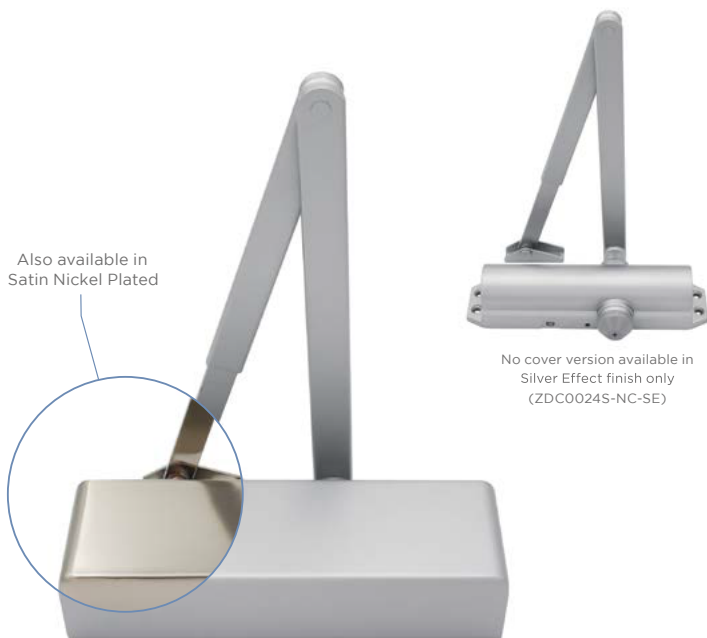

TECHNICAL SPECIFICATION

PRODUCT FEATURES

- **Power size:** Size 2-4 selectable
- **Body material:** Aluminium
- **Arm set type / material:** Scissor / Steel
- **Functions:** Tested functions - Closing speed - All applications, Latching speed - (Fig 1 and 61 only)
- **Maximum door weight:** 80kgs (door mount pull) 60kgs (door and frame mount push)
- **Maximum door width:** 1100mm (door mount pull) 950mm (door and frame mount push)
- **Performance Testing:** Successfully tested in accordance with the requirements of BS EN1154: 1997

Classification: Door mount pull side (Fig 1).

3	8	4/2	1	1	3
---	---	-----	---	---	---

Classification: Door mount push side (Fig 6)

3	8	3	1	1	3
---	---	---	---	---	---

Classification: Frame mount push side, zero head projection (Fig 61)

4	8	3/2	1	1	3
---	---	-----	---	---	---

FIRE TESTING

- Successfully fire tested in accordance with the requirements of BS EN1634-1, suitable for use on up to 120 minute timber fire doors
- Backcheck is not suitable for use on fire resistant doors

CERTIFICATION

- UKCA marked (Certificate AD7993)
- CE marked (Certificate AD8001)
- CERTIFIRE approved (Certificate CF6103)



COVER OPTIONS

- Semi-radiused

FINISHES

- Silver (SE)
- Satin Nickel Plated (SN)

*Other finishes available on request

CODE	DESCRIPTION	FINISH
ZDC0024S-NC-SE	Size 2-4 Selectable Overhead Door Closer, Matching Finish Armset/Fig 6 Bracket, No Cover	Silver
ZDC0024S-SE	Size 2-4 Selectable Overhead Door Closer, Matching Finish Armset/Cover/Fig 6 Bracket	Silver
ZDC0024S-SN	Size 2-4 Selectable Overhead Door Closer, Matching Finish Armset/Cover/Fig 6 Bracket	Satin Nickel Plated
	<p>For more information please contact us today: ERA Home Security T/A Zoo Hardware, Unit B, Dukes Drive, Kingmoor Park North, Carlisle, Cumbria CA6 4SH</p> <p>Call: 01228 672900 Fax: 01228 672928 Email: sales@zoo-hardware.co.uk Web: www.zoohardware.co.uk</p>	 FM 668401 EMS 668402